



Security 1st Title

TITLE INSURANCE | CLOSINGS | 1031 EXCHANGE | CONTRACT SERVICING | **SECURITY1STKS.COM**

MCPHERSON, RENO, RICE & STAFFORD COUNTY

TITLE INSURANCE CHARGES | EFFECTIVE NOVEMBER 15, 2016

Amounts Up To	Rate	Reissue Refi/2nd	Amounts Up To	Rate	Reissue Refi/2nd	Amounts Up To	Rate	Reissue Refi/2nd	Amounts Up To	Rate	Reissue Refi/2nd
10,000	240	240	260,000	860	516	510,000	1,360	816	760,000	1,860	1,116
20,000	290	240	270,000	880	528	520,000	1,380	828	770,000	1,880	1,128
30,000	320	240	280,000	900	540	530,000	1,400	840	780,000	1,900	1,140
40,000	355	240	290,000	920	552	540,000	1,420	852	790,000	1,920	1,152
50,000	390	240	300,000	940	564	550,000	1,440	864	800,000	1,940	1,164
60,000	420	252	310,000	960	576	560,000	1,460	876	810,000	1,960	1,176
70,000	450	270	320,000	980	588	570,000	1,480	888	820,000	1,980	1,188
80,000	480	288	330,000	1,000	600	580,000	1,500	900	830,000	2,000	1,200
90,000	510	306	340,000	1,020	612	590,000	1,520	912	840,000	2,020	1,212
100,000	540	324	350,000	1,040	624	600,000	1,540	924	850,000	2,040	1,224
110,000	560	336	360,000	1,060	636	610,000	1,560	936	860,000	2,060	1,236
120,000	580	348	370,000	1,080	648	620,000	1,580	948	870,000	2,080	1,248
130,000	600	360	380,000	1,100	660	630,000	1,600	960	880,000	2,100	1,260
140,000	620	372	390,000	1,120	672	640,000	1,620	972	890,000	2,120	1,272
150,000	640	384	400,000	1,140	684	650,000	1,640	984	900,000	2,140	1,284
160,000	660	396	410,000	1,160	696	660,000	1,660	996	910,000	2,160	1,296
170,000	680	408	420,000	1,180	708	670,000	1,680	1,008	920,000	2,180	1,308
180,000	700	420	430,000	1,200	720	680,000	1,700	1,020	930,000	2,200	1,320
190,000	720	432	440,000	1,220	732	690,000	1,720	1,032	940,000	2,220	1,332
200,000	740	444	450,000	1,240	744	700,000	1,740	1,044	950,000	2,240	1,344
210,000	760	456	460,000	1,260	756	710,000	1,760	1,056	960,000	2,260	1,356
220,000	780	468	470,000	1,280	768	720,000	1,780	1,068	970,000	2,280	1,368
230,000	800	480	480,000	1,300	780	730,000	1,800	1,080	980,000	2,300	1,380
240,000	820	492	490,000	1,320	792	740,000	1,820	1,092	990,000	2,320	1,392
250,000	840	504	500,000	1,340	804	750,000	1,840	1,104	1,000,000	2,340	1,404

CLOSING FEES (policy purchase required)

RESIDENTIAL SALE WITH LOAN \$400.00

RESIDENTIAL REFINANCE \$300.00 | RESIDENTIAL SALE WITH CASH \$250.00

COMMERCIAL & AGRICULTURAL

\$1.00/1,000 up to 1,000,000 | plus 10¢/1,000 over 1,000,000 (\$400.00 min.)

- * The charges published herein are applicable to normal transactions. In cases involving long and intricate title, more than one chain of title or extraordinary risk, we reserve the right to make additional changes.
- ** Multiple lot and new home sales may be subject to special builders and developers rates and are not listed above. Call us for special quotations.
- *** For residential mortgage policies not exceeding the amount of the owners policy, but issued simultaneously \$125.00.
- **** For sale of residential property within three years of seller's purchase, use Reissue rate.
- ***** For policies over \$1,000,000 and simultaneous leasehold policies, charges will be furnished upon request.



Security 1st Title

MCPHERSON COUNTY | 211 W. Kansas Ave. | McPherson, KS 67460 | (620) 241-1317

RENO COUNTY | 1001 N. Main | Hutchinson, KS 67501 | (620) 669-8289

RICE COUNTY | 108 E. Avenue South | Lyons, KS 67554 | (620) 257-2831

STAFFORD COUNTY | 201 E. 3rd St., P.O. Box 21 | St. John, KS 67576 | (620) 549-3374

SECTION OF LAND | 640 Acres or one square mile

NW SEC COR

N 1/4 COR

NE SEC COR

Table of Measurements

- One Chain = 100lks = 4rds = 66ft
- One Link = 0.01chs = 0.04rds = 0.66ft = 7.92in
- One Rod = 0.25chs = 25lks = 16.5ft
- One Mile = 80chs = 320rds = 5280ft
- One Square Mile = 640acs = 6400sq Chs
- One Acre = 10sq Chs = 160sq Rds = 43560sq Ft
- Side Of A Square Acre = 208.71ft
- One Arpent = 0.848398acs = 36956.2176sq Ft
- Side Of An Arpent = 291.27chs = 192.24ft
- One Square Rod = 272.25sq Ft
- Strip Of Land 1 Rod Wide & 0.5 Mile Long = 1 Acre
- One Acre = 16.5'x2640' = 33'x1320' = 66'x660' = 132'x330' = 264'x165'

NW 1/4

1/4 LINE

1/2 mi = 40 chns = 160 rds = 880 yds = 2640 ft

NE 1/4

CEN 1/4 COR 20chns

N and S

S 1/4 COR

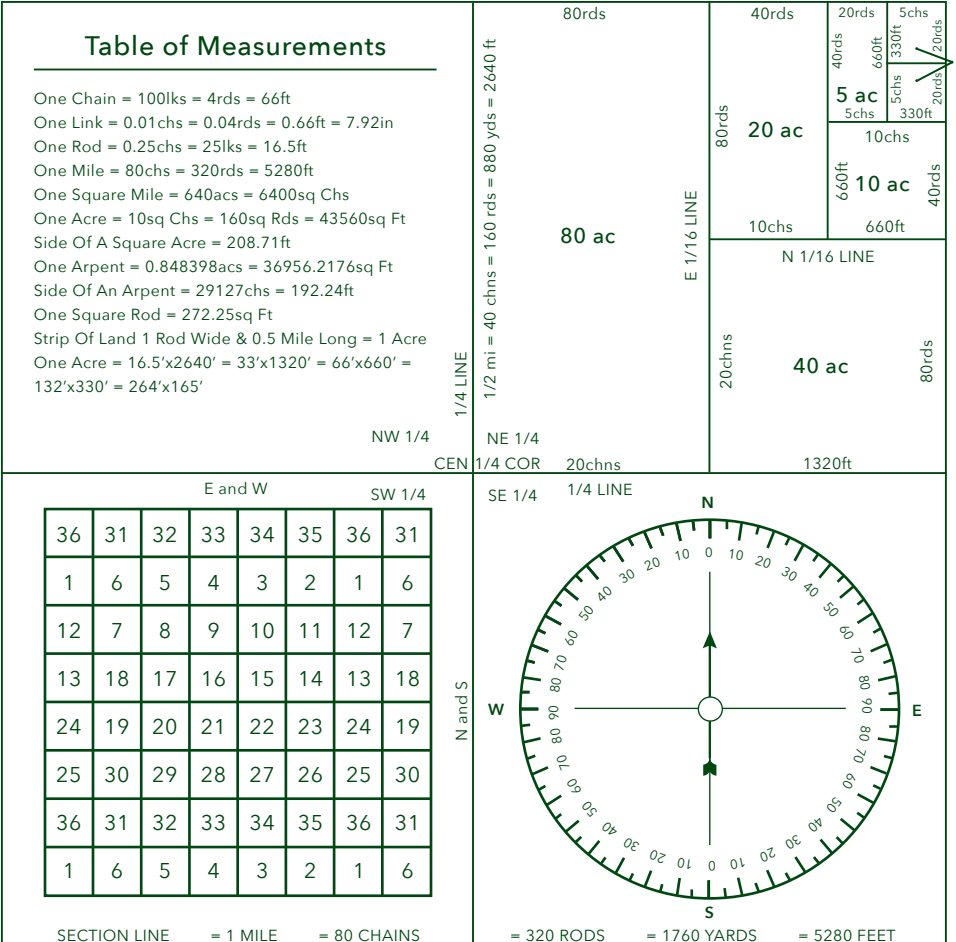

W 1/4 COR

E 1/4 COR

SW SEC COR

SE SEC COR

TITLE INSURANCE | CLOSINGS | 1031 EXCHANGE | CONTRACT SERVICING

VISIT US ONLINE AT WWW.SECURITY1STKS.COM