



# Security 1<sup>st</sup> Title

TITLE INSURANCE | CLOSINGS | 1031 EXCHANGE | CONTRACT SERVICING | [SECURITY1ST.COM](http://SECURITY1ST.COM)

## MARION COUNTY TITLE INSURANCE CHARGES

EFFECTIVE FEBRUARY 7, 2018

Amounts Up To	Rate	Amounts Up To	Rate	Amounts Up To	Rate	Amounts Up To	Rate
10,000	240	260,000	960	510,000	1,460	760,000	1,960
20,000	280	270,000	980	520,000	1,480	770,000	1,980
30,000	325	280,000	1,000	530,000	1,500	780,000	2,000
40,000	370	290,000	1,020	540,000	1,520	790,000	2,020
50,000	415	300,000	1,040	550,000	1,540	800,000	2,040
60,000	460	310,000	1,060	560,000	1,560	810,000	2,060
70,000	505	320,000	1,080	570,000	1,580	820,000	2,080
80,000	550	330,000	1,100	580,000	1,600	830,000	2,100
90,000	595	340,000	1,120	590,000	1,620	840,000	2,120
100,000	640	350,000	1,140	600,000	1,640	850,000	2,140
110,000	660	360,000	1,160	610,000	1,660	860,000	2,160
120,000	680	370,000	1,180	620,000	1,680	870,000	2,180
130,000	700	380,000	1,200	630,000	1,700	880,000	2,200
140,000	720	390,000	1,220	640,000	1,720	890,000	2,220
150,000	740	400,000	1,240	650,000	1,740	900,000	2,240
160,000	760	410,000	1,260	660,000	1,760	910,000	2,260
170,000	780	420,000	1,280	670,000	1,780	920,000	2,280
180,000	800	430,000	1,300	680,000	1,800	930,000	2,300
190,000	820	440,000	1,320	690,000	1,820	940,000	2,320
200,000	840	450,000	1,340	700,000	1,840	950,000	2,340
210,000	860	460,000	1,360	710,000	1,860	960,000	2,360
220,000	880	470,000	1,380	720,000	1,880	970,000	2,380
230,000	900	480,000	1,400	730,000	1,900	980,000	2,400
240,000	920	490,000	1,420	740,000	1,920	990,000	2,420
250,000	940	500,000	1,440	750,000	1,940	1,000,000	2,440

### CLOSING FEES (policy purchase required)

RESIDENTIAL SALE \$430.00 | RESIDENTIAL REFINANCE \$300.00

#### COMMERCIAL & AGRICULTURAL

\$1.00/1,000 up to 1,000,000 | plus 10¢/1,000 over 1,000,000 (\$400.00 min.)

- \* The charges published herein are applicable to normal transactions. In cases involving long and intricate title, more than one chain of title or extraordinary risk, we reserve the right to make additional changes.
- \*\* Multiple lot and new home sales may be subject to special builders and developers rates and are not listed above. Call us for special quotations.
- \*\*\* For residential mortgage policies not exceeding the amount of the owners policy, but issued simultaneously \$175.00.
- \*\*\*\* For policies over \$1,000,000 and simultaneous leasehold policies, charges will be furnished upon request.



# Security 1<sup>st</sup> Title

MARION | 222 E. Main St. | Marion, KS 66861 | (620) 382-2130

## SECTION OF LAND | 640 Acres or one square mile

NW SEC COR

N 1/4 COR

NE SEC COR

### Table of Measurements

- One Chain = 100lks = 4rds = 66ft
- One Link = 0.01chs = 0.04rds = 0.66ft = 7.92in
- One Rod = 0.25chs = 25lks = 16.5ft
- One Mile = 80chs = 320rds = 5280ft
- One Square Mile = 640acs = 6400sq Chs
- One Acre = 10sq Chs = 160sq Rds = 43560sq Ft
- Side Of A Square Acre = 208.71ft
- One Arpent = 0.848398acs = 36956.2176sq Ft
- Side Of An Arpent = 29127chs = 192.24ft
- One Square Rod = 272.25sq Ft
- Strip Of Land 1 Rod Wide & 0.5 Mile Long = 1 Acre
- One Acre = 16.5'x2640' = 33'x1320' = 66'x660' = 132'x330' = 264'x165'

NW 1/4

NE 1/4

CEN

1/4 COR

20chns

1320ft

E and W

SW 1/4

36	31	32	33	34	35	36	31
1	6	5	4	3	2	1	6
12	7	8	9	10	11	12	7
13	18	17	16	15	14	13	18
24	19	20	21	22	23	24	19
25	30	29	28	27	26	25	30
36	31	32	33	34	35	36	31
1	6	5	4	3	2	1	6

SECTION LINE = 1 MILE = 80 CHAINS

= 320 RODS = 1760 YARDS = 5280 FEET

SW SEC COR

S 1/4 COR

SE SEC COR

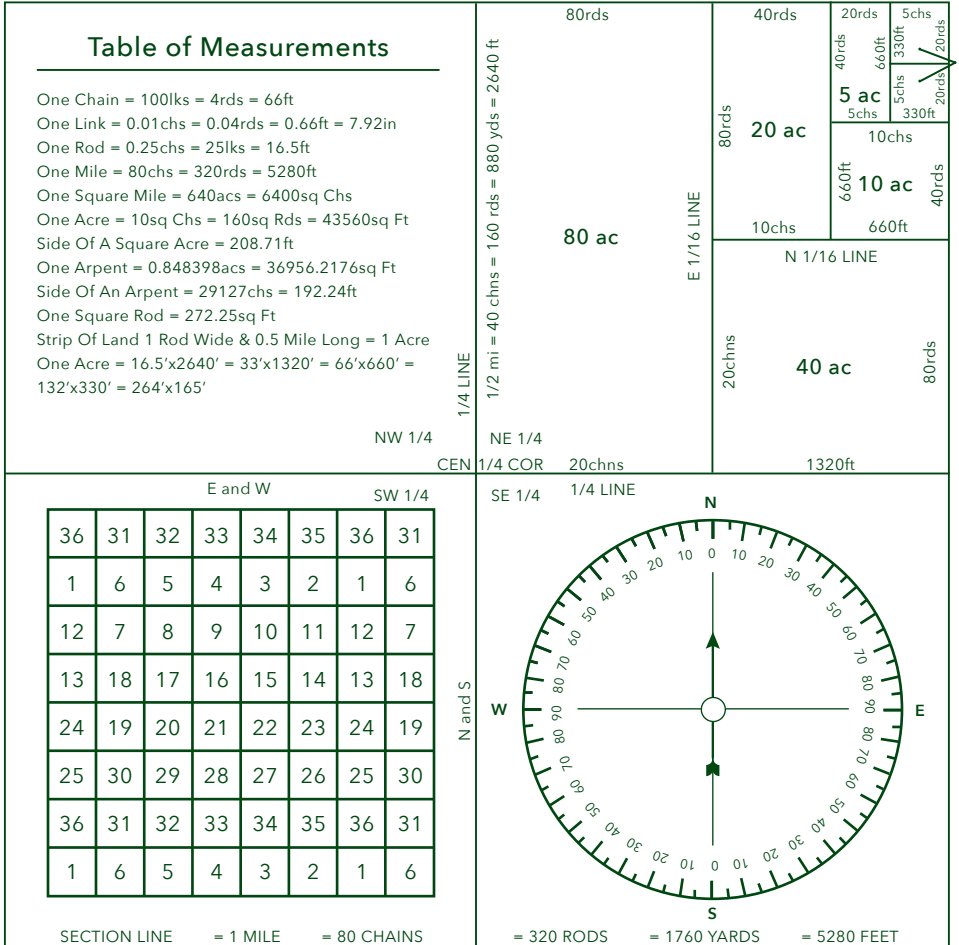
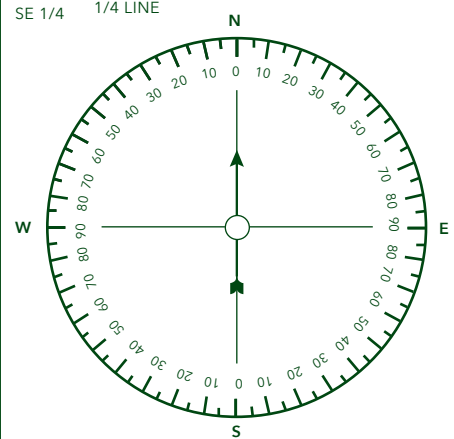

W 1/4 COR

E 1/4 COR

2.5ac

TITLE INSURANCE | CLOSINGS | 1031 EXCHANGE | CONTRACT SERVICING

VISIT US ONLINE AT [WWW.SECURITY1ST.COM](http://WWW.SECURITY1ST.COM)